

PAD

BeCode



BeCode PAD

Base: black

Front: brushed stainless steel

Artikel-Nr. 7-1-0602



Advantages at a glance:

- integrated lever lock
- fast, intuitive operation
- no keys or transponder required
- wireless installation
- abort function for incorrect code entry
- no external programming devices needed
- master code possible
- front-flush fit
- exterior emergency power supply
- access data can be read
- individual laser marking possible
- proven protection against vandalism
- extremely long lifespan thanks to innovative energy management

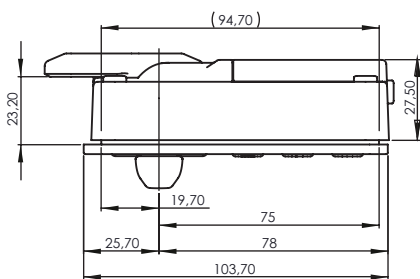
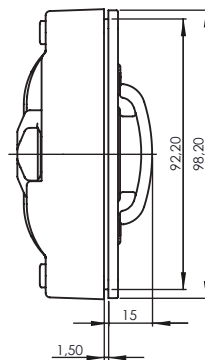
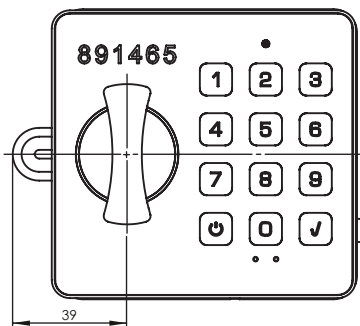

Hole Pattern

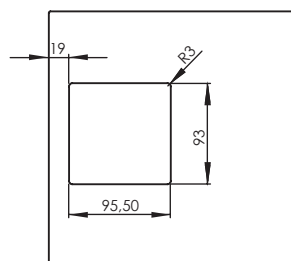

The BeCode PAD is another addition to the Beloxx product range.

The BeCode PAD keypad lock is an excellent alternative to the BeCode EVO/ EVO+ turn locks and the radio-controlled BeCode AIR/AIR+ . Beloxx's highly efficient energy management means that the lock can function for up to 20 years without a change of batteries (up to a maximum of 1,000 closures per month).

The BeCode PAD is available in TAN mode. This system offers high-level security encryption that creates and allocates user codes independently. It can also be operated using various other software functions that are already familiar from the BeCode EVO/EVO+.

